

City of Nashua
Planning Department
 229 Main Street
 Nashua, New Hampshire 03061-2019

Planning & Zoning 589-3090
 WEB www.nashuanh.gov

HISTORIC DISTRICT COMMISSION APPLICATION

PLEASE NOTE: INCOMPLETE OR ILLEGIBLE APPLICATIONS WILL BE RETURNED TO APPLICANT.

Location 23 Main St

Zoning District D-1/MU Sheet 68 Lot 5 Property Acct# 10,238

Property Owner (print name) PARENT REALTY LLC

Owner's Signature [Signature] Date 7-16-19

Owner's Address 130 Redoubt Rd.

Telephone Number H: C:603-266-5477 E-mail _____

Applicant (print name) William Parrish

Applicant's Signature [Signature] Date 7-16-19

Applicant's Address 35 S Chestnut St 0835 Haverhill, MA

Telephone Number H: C:978-273-5108 E-mail B.Parrish778@amsi.com

Proposed Work: Replace existing Hood Fan and Duct work with new Duct and Fan

Construct Repair Add Signage Demolish
 Alter Replace Change Signage Other

At the 8-26-19 Historic District Commission (HDC) meeting, the above application was:

Approved Disapproved Tabled Postponed

The HDC found the proposed: Does / Does Not meeting the requirements of the regulations for the District. The following stipulations shall apply:

Chairman/designee _____ Date _____

OFFICE USE ONLY Date Received 7/29/19 Date of hearing 8/26/19 Application checked for completeness: _____
 PLR# 2019-00130 Board Action _____
 \$ _____ application fee \$ _____ signage fee Date Paid _____ Receipt # _____

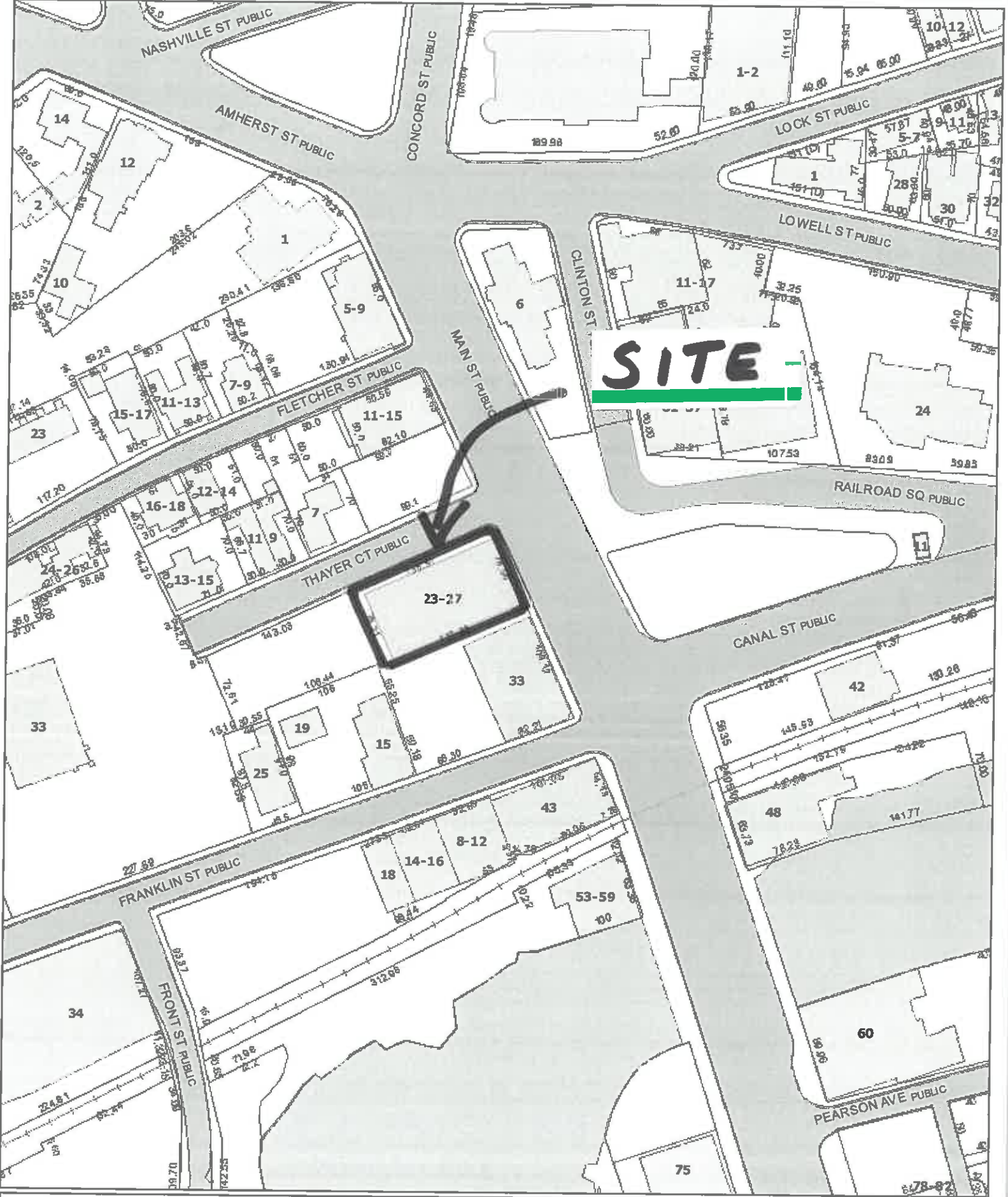

SITE

23 Main Street

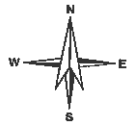

EXHAUST FAN INFORMATION -- 44-30000000

FAN UNIT NO.	FAN UNIT MODEL #	CFM	HP	WTR	H.P.	W.P.	#	VOLT	FLA	DISCHARGE VELOCITY	WEIGHT (LBS)	ORDER #
1	DAW07A	2400	0.450	13.5V	0.008	0.2000	1	120	0.4	0.000 FPM	86	23.4

FAN OPTIONS

UNIT NO.	OPTION	DESCRIPTION
1	1	Minimum Relay Size of #
1	2	Wall Mount Construction for Fan
1	3	Shop Loose Backwash Fan Assembly Required

FAN ACCESSORIES

FAN UNIT NO.	EXHAUST	WALL MOUNT	WALL MOUNT	WALL MOUNT	WALL MOUNT	WALL MOUNT	WALL MOUNT	WALL MOUNT	WALL MOUNT
	WALL MOUNT	WALL MOUNT	WALL MOUNT	WALL MOUNT	WALL MOUNT	WALL MOUNT	WALL MOUNT	WALL MOUNT	WALL MOUNT
1									

CUSTOMER APPROVAL TO MANUFACTURE

Approved as Shown

Approved with AG Exception Taken

Revised and Resubmit

SIGNATURE _____ DATE _____

FIG. 10. DAW07A - EXHAUST FAN

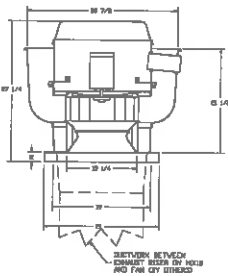

FEATURES

- BRISTLE BRUSH CONSTRUCTION FOR SELF-CLEANING
- SELF-HEATING FAN
- POLYMER CASE
- ULTRAP
- VARIABLE SPEED CONTROL
- INTERNAL VIBRATOR
- MOUNTING BRACKET
- FERRULE SHIELDING PROTECTION (OPTIONAL FINISH)
- 100% RECYCLED BODY GROUP

ROOM TEMPERATURE TEST
 CONDUCT FAN TEST DURING CONTINUOUSLY VARIABLE FREQUENCY AIR AT 200% DUTY CYCLE. ALL FAN TESTS SHOULD BE CONDUCTED AT 100% DUTY CYCLE. ALL TESTS SHOULD BE CONDUCTED AT 100% DUTY CYCLE.

REVISION
 1 - WALL MOUNT KIT TO 2.5"
 2 - WALL MOUNT BRACKET FOR FAN
 3 - WALL MOUNT BRACKET FOR FAN

WALL MOUNT BRACKET

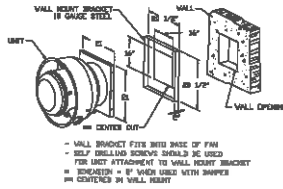

Revision	By	Date	Description
1	MRG	7/2/2019	WALL MOUNT KIT TO 2.5"
2	MRG		WALL MOUNT BRACKET FOR FAN
3	MRG		WALL MOUNT BRACKET FOR FAN

CAPTIVE

Soprano's Pizza - Nashua, NH
 NORTH BILLERICA, MA

DATE: 7/2/2019
 DRAWN: 309665
 CHECKED: MRG
 SCALE: 3/4" = 1'-0"
 SHEET NO. 1

DuctWork #1 SE View

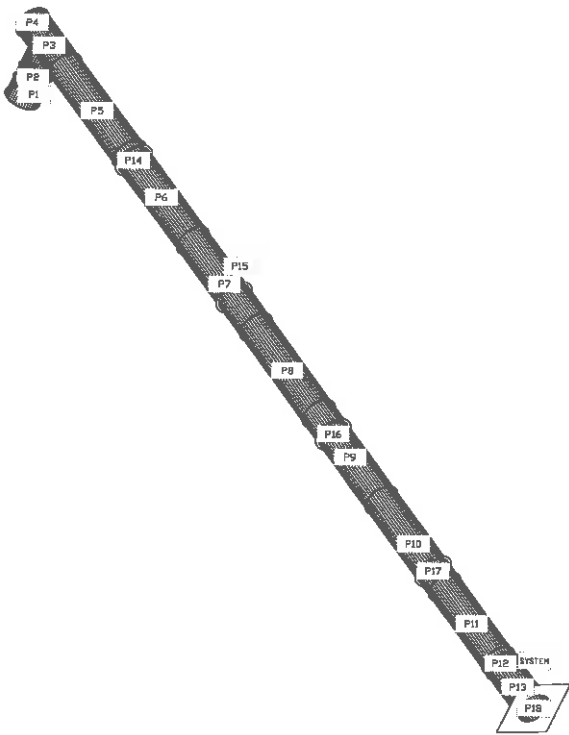

CUSTOMER APPROVAL TO MANUFACTURE	
Approved as Shown	<input type="checkbox"/>
Approved with 30 Day Contingency Taken	<input type="checkbox"/>
Revised and Resubmit	<input type="checkbox"/>
SIGNATURE	_____
Year: 1986	Day: _____

Soprano's Pizza - Nashua, NH NORTH BILLERICA, MA,	
DATE: 7/2/2018	PROJECT: 3870569
SCALE: 3/4" = 1'-0"	SCALE: 3/4" = 1'-0"
SOLELY DRG. 4	

To Be Removed



NEW Hood fan



THE PARKING CORNER